

TLB990

In a league of its own

The TLB990 backhoe loader is designed for professionals who demand the highest performance and cost effective operation all-year-round with an excellent return on investment.

The four wheel steering system combined with four wheel drive provides excellent traction that allows the TLB990 to keep working in conditions where other backhoes simply cannot.

The crab steer mode allows the TLB990 backhoe loader to operate in the tightest of spaces reducing the need for additional machines. You can select between two, four and crab steering modes with the flick of a switch.

What this means for you

- ▶ Four wheel steering provides a turning circle of only 7.3m
- ▶ Identical size wheels all around for higher flotation
- ▶ Crab steer mode allows access into tight areas



Y IN MOTION



LOADER DIMENSIONS

	Standard / 7 in 1 Bucket mm (ft)
N. Dump Clearance – at 45°	2906 (9'6")
O. Loadover Height	3425 (11'3")
P. Hinge Pin Height	3671 (12'0")
Q. Pin Forward Reach	315 (1'0")
R. Reach at Ground	1451 (4'9")
S. Max. Reach at Full Height	1186 (3'11")
T. Reach at Full Height – at 45°	731 (2'5")
U. Dig Depth	100 (4")
Rollback at Ground	50°
Max. Dump Angle Fully Raised	47°
V. Overall Operating Height	4738 (15'6")

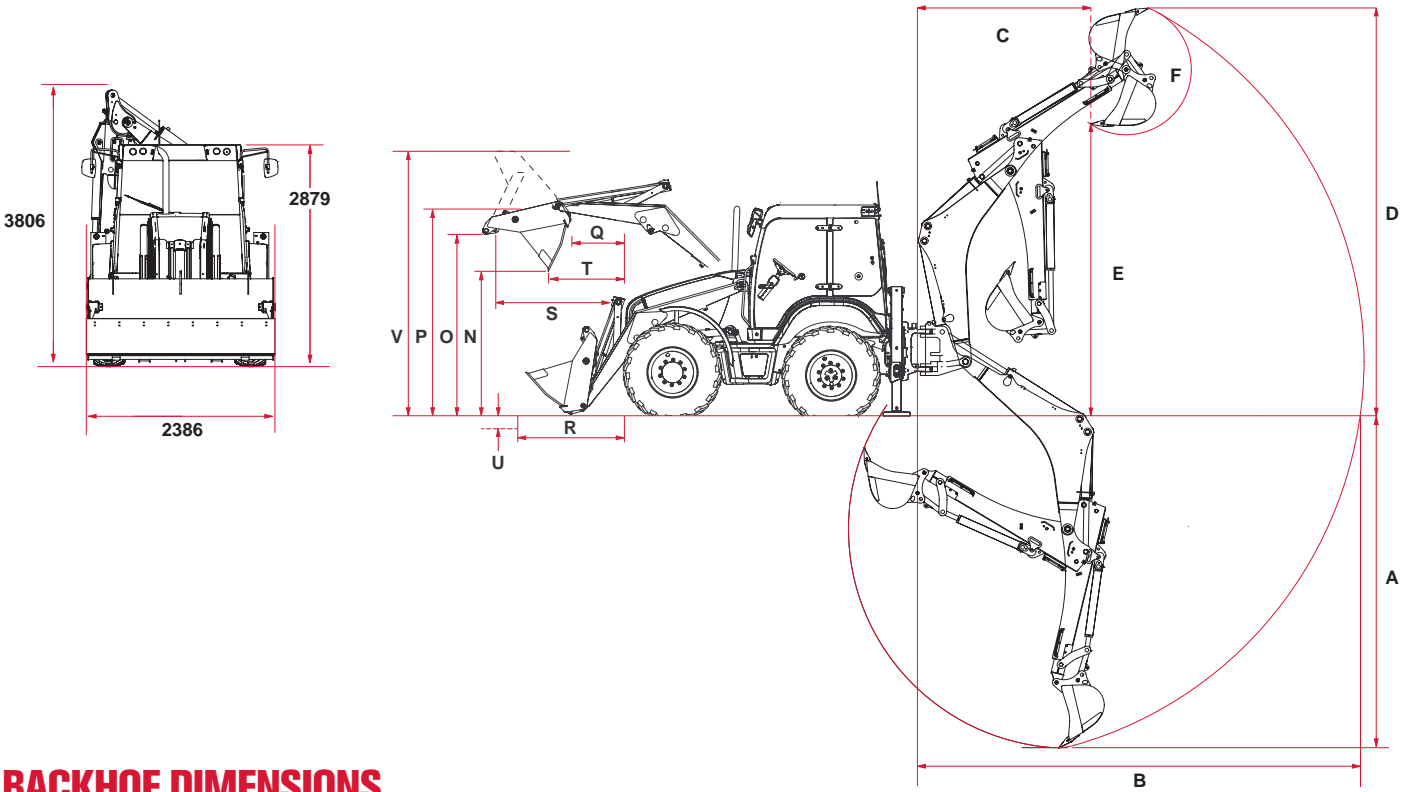
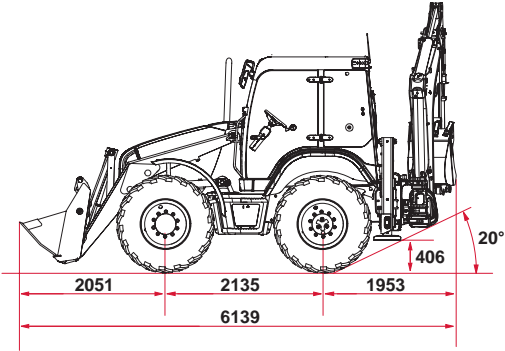

BACKHOE DIMENSIONS

Standard Dipper – mm (ft)			Deep Dig Dipper – mm (ft)	
			Retracted	Extended
A. Dig Depth	Maximum SAE	4442 (14'7")	4498 (14'9")	5642 (18'6")
	2ft Flat Bottom SAE	4392 (14'5")	4448 (14'7")	5556 (18'3")
B. Reach - Ground Level to slew		5877 (19'3")	5877 (19'3")	6950 (22'10")
C. Loading Reach		2274 (7'6")	2274 (7'6")	3293 (10'10")
D. Operating Height		5565 (18'3")	5509 (18'1")	6199 (20'4")
E. Loading Height SAE		3911 (12'10")	3855 (12'8")	4545 (14'11")
	Max Dumping Height	3847 (12'7")	3791 (12'5")	4480 (14'8")
F. Bucket Rotation Degrees	Speed	197	197	197
	Power	166	166	166
Total Sideshift		1178 (3'10")	1178 (3'10")	1178 (3'10")
Stabiliser Spread		2115 (6'11")	2115 (6'11")	2115 (6'11")
Max. Levelling Angle Degrees		8	8	8

SPECIFICATIONS

BACKHOE PERFORMANCE

		Standard Dipper		Deep Dig Dipper			
				Retracted		Extended	
		Standard Bucket	HD Bucket	Standard Bucket	HD Bucket	Standard Bucket	HD Bucket
Max Slew Torque kNm		27.8		27.8		27.8	
Dipper Tearout kN (lbf) (SAE J49 Standard)		41.1 (9240)	41.1 (9240)	41.1 (9240)	41.1 (9240)	29 (6519)	29 (6519)
Bucket Tearout kN (lbf) (SAE J49 Standard)	Speed Dig	60.3 (13556)	60.3 (13556)	60.3 (13556)	60.3 (13556)	60.3 (13556)	60.3 (13556)
	Power Dig	–	67.8 (15242)	–	67.8 (15242)	–	67.8 (15242)

LOADER PERFORMANCE

	Standard Bucket	7 in 1 Bucket
Bucket Breakout kN (lbf)	55.4 (12454)	53.7 (12072)
Arms Breakout kN (lbf)	51.1 (11487)	47.8 (10746)
Rated Operating Capacity (ISO 14397) (lb)	3503 kg (7722)	3166 kg (6980)
Hydraulic Lift Capacity to full height (lb)	3966 kg (8744)	3629 kg (8000)

Loader specifications are stated in accordance with ISO 14397 and EN474 Part 4.

PALLET FORKS

(Standard / 7 in 1 buckets)

Fork Length	mm (ft)	1067 (3'6")
Section Width	mm (ins)	80 (3")
Assembly Weight	kg (lb)	150 (330)
Max. Operating Height	mm (ft)	3153 (10'4")
Reach At Ground Level	mm (ft)	2660 (8'9")
Reach At Full Height	mm (ft)	2251 (7'5")
S.W.L. At 500mm Load Centre	kg (lb)	1000 (2204)

SIDESHIFT BACKHOE

Load Chart for Extending Dipperstick using boom cylinder for object handling

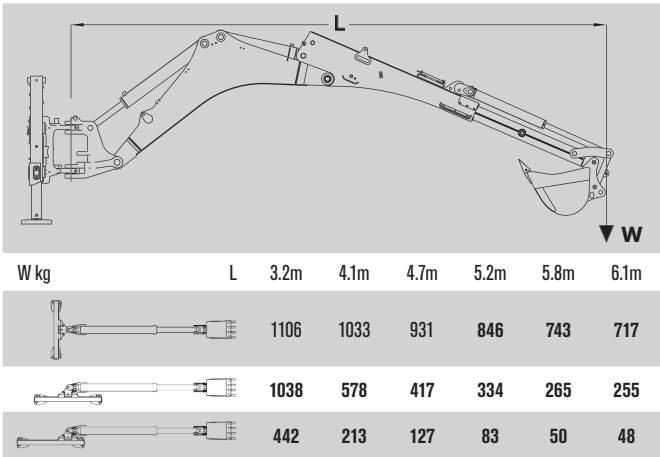

Backhoe Configuration (Top to Bottom)

- Centrally located 'over end' lift capacity (within 45° either side of the machine centreline)
- Centrally located lift capacity through the full swing arc
- Fully offset lift capacity through the full swing arc

Note

- Standard 600mm (24") bucket fitted, for larger buckets subtract difference in weight from stated lift capacity
- Figures stated are rated capacities, and are the lower of either the rated hydraulic lift capacity, or rated tipping load
- Figures in bold print are stability limited figures

BACKHOE BUCKETS

Bucket	Width mm (ins)	Capacity m³ (ft³)	Weight Kg (lbs)
Standard Trenching	305 (12)	0.074 (2.62)	99 (218)
	450 (18)	0.120 (4.25)	114 (251)
	600 (24)	0.177 (6.26)	136 (300)
	750 (30)	0.236 (8.32)	157 (346)
Heavy Duty	900 (36)	0.296 (10.44)	178 (392)
	305 (12)	0.084 (2.96)	112 (247)
	450 (18)	0.140 (4.96)	128 (282)
	600 (24)	0.203 (7.15)	152 (335)
Ditch Cleaning	750 (30)	0.266 (9.38)	174 (383)
	900 (36)	0.330 (11.66)	198 (436)
	1500 (60)	0.262 (9.2)	180 (397)
	1800 (72)	0.317 (11.2)	204 (450)
Trapezoidal	1200 (48)	0.258 (9.1)	146 (322)

LOADER BUCKETS

	Standard Bucket	7 in 1 Bucket
Width	mm (ft)	2386 (7'8")
Capacity	m³ (yd³)	1.2 (1.57)
Weight	Kg (lbs)	430 (948)

Load Chart for Standard Dipperstick using boom cylinder for object handling

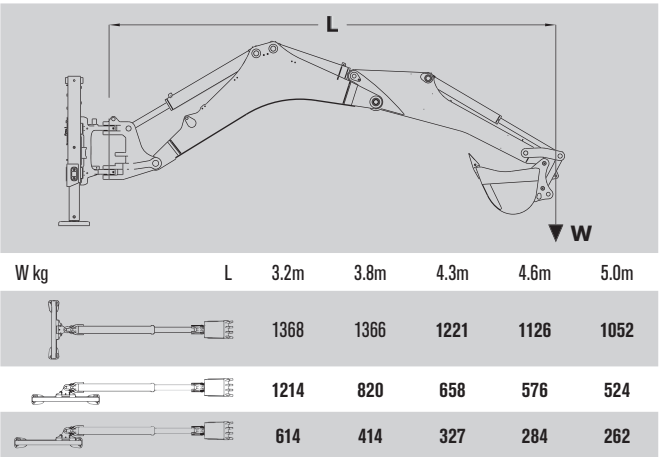

STANDARD AND OPTIONAL EQUIPMENT

NOTE: Standard and Optional equipment can vary by territory

ENGINE

Perkins 1204E-E44TA (Stage IIIB/Tier 4i)
Wastegate turbo and charge air cooled
Electric fuel pump
Electronic fuel injection
Auto Idle
4 Glow plug starting aid
Horizontal spin on oil filter
Primary fuel filter with water separator
Vertical element secondary fuel filter
In line fuel filter
500 hour service period
Oil to water internal plate oil cooler
Engine gradeability fore/aft and side/ side 30°
Anti-freeze rated to -37° C
Coolant header tank
Alternator and fan drive by polygroove belt
Gear driven water pump
Puller type 9 bladed cooling fan
Dual element Powercore air cleaner
Stainless steel aftertreatment and exhaust stack
OPTION: Fan guard

DRIVELINE

Direction control with neutral safety interlock
Servo power synchro transmission 4F/3R speeds
Column mounted rotational control lever
Automatic up and down shifting
Auto change down 4/3 and back
Kick down 2/1 and Kick up 1/2
Torque Convertor stall ratio 3.01:1
Easy clean transmission oil cooler
Vertical element oil filter
Foot operated electro/hydraulic differential lock
Outboard Planetary final drive axles
Large capacity inboard oil immersed disc brakes <ul style="list-style-type: none"> • 3 Kevlar friction discs (222mm dia) per side • Total friction area per side 1070cm² (166in²)
Brakes self adjusting and self equalising
Dual brake pedals with combined or independent use
Internal wet disc parking brake <ul style="list-style-type: none"> • Max Parking Slope (unladen) 1:2 • Max Parking Slope (laden) 1:2.5
Hydrostatic steering with emergency manual operation.
4WD standard
Selectable 2 and 4 wheel braking in all gears
Selectable 2WD and 4WD

CAB

ROPS/FOPS conform to ISO 3471/3449
Self cleaning footsteps and large grab handles
Internal rear view mirror
Folding external rear view mirrors
2 cup holders
Coat hook
Tilt and Telescopic steering wheel
Front and rear horn
Seat storage for operators manual
2 in (51mm) retractable seat belt
3 auxiliary 12 volt outlets
Cab with 2 door access
Partial door locking
Opening rear quarter windows with internal operation
Full depth up and over rear window
Laminated windscreen
Tinted toughened safety glass
Front and rear screen washers and wipers
Standard fabric seat with mechanical suspension
Heater (7.37kW)
Lockable chilled storage box
Digital clock
Cell phone holder with power plug
Pre installation of wiring for radio
Internal noise level 78 dB(a)
12 audible and visual warning lamps
Engine hour meter
4 rear work lights
3 Gauges for engine oil temperature, fuel and rpm
2 external power sockets for beacon
CAB OPTIONS: <ul style="list-style-type: none"> • Air conditioning (7.6 kW cooling) • Automatic Temperature Control • Premium high back seat, heated with air suspension • 3 in seat belt • Speedometer

LOADER

Hydro-Mechanical self levelling
Multifunctional control lever
Single bucket cylinder
Bucket cylinder cushioning
Return to dig
Float position with positive hold
Bucket level indicator
Integral Loader arm safety bar
Standard bucket 1.2m ³ with lifting eye
7 in 1 bucket 1.2m ³ with lifting eye
Bucket teeth or bolt on reversible cutting edge
7 in 1 bucket operation by thumb slider control
OPTIONS: <ul style="list-style-type: none"> • Pallet forks with safe working load of 1000kgs • 3rd hydraulic line with standard bucket • Hose burst valves • Ride control • Bucket tooth guard • Mechanical or hydraulic quick attach

BACKHOE

Curved style boom
Standard dipperstick
Inner slide "Deep Dig" dipperstick
Externally adjustable lubrication free wear pads (8)
Electro/hydraulic dual transport lock
Externally adjustable stabiliser wear pads
SAE/ISO/Diagonal 2 lever controls
Standard trenching buckets with reversible side cutters
OPTIONS: <ul style="list-style-type: none"> • Stabiliser lock out valves • Boom and Dipper hose burst valves • Hydraulic and Mechanical quick attach • Two auxiliary circuits with single and double acting operation • HD buckets with power and speed positions • Object handling kit • Quick release rubber street pads

GENERAL POINTS

Heavy duty chassis construction
Lockable side mounted toolbox
Fully tilting engine hood
Front hard nose counterweight
Lifting eyes and Tie downs (2 front and rear)
Tandem gear pump hydraulics with mechanically operated Backhoe controls
Variable f ow hydraulics with pilot operated Backhoe controls
Pilot controls with constant f ow feature
OPTIONS: <ul style="list-style-type: none"> • Reverse Warning Alarm • Front Fenders • Premium Brand Tyres